

Maule Aircraft Corporation

SPENCE AIR BASE :: MOULTREE, GEORGIA 31768 :: PHONE 912/985-2045



14 September 1982
Page 1 of 2

SERVICE LETTER #47

SUBJECT: New Flap Ratchet.

AIRCRAFT AFFECTED: MAULE Model M-5-210TC, Serial No's 9001C thru 9010C.

COMPLIANCE: Optional.

AUTHORITY: This Service Letter is FAA Approved.

BACKGROUND: Many MAULE owners have requested increased flap travel for their airplanes. The new flap ratchet allows 5° - 8° more travel at each setting. There is also available an alternate lever which is bent upward. This allows more clearance under the lever for easier grasping. Either unit can be used separately.

MATERIAL REQUIRED:

- (1) Flap Ratchet p/n 3207B
- (1) Alternate Flap Lever Assembly p/n 3058F-28 (opt.)
- (1) Flap Handle Placard (20°-40°)
- (1) Installation Sketch

INSTALLATION INSTRUCTIONS AND ACTION TO BE TAKEN:

1. Remove left front seat.
2. Remove control cover (ref. Item 6, Group C-4 of Parts Catalog)
3. Remove old ratchet:
 - (a) Remove forward ratchet attach bolt and nut.
 - (b) Remove aft stop bolt and nut.
 - (c) Slide ratchet forward thru plates of flap handle assembly.
4. Install new ratchet:
 - (a) Slide ratchet aft thru plates of flap handle assembly.
 - (b) Install forward attach bolt and nut and secure with cotter pin.
 - (c) Install aft stop bolt and nut removed from old ratchet.
NOTE: 20°-40° ratchet has forward stop bolt and nut deleted.
 - (d) Operational check flap system.
5. Reinstall control cover.
6. Reinstall left front seat.
7. Remove 15°-35° placard from flap handle and apply new placard.
8. Remark Airspeed Indicator: Extend white arc from 60 to 54 mph by applying white tape over instrument glass. Add slippage mark by painting a thin white line over glass and bezel.
9. Attach AFM Supplement No. 1 to FAA approved Airplane Flight Manual dated 4 February 1980.

When modification is completed, make proper log entries, fill out Service Letter #47 Compliance Record Sheet and return.

INSTALLATION INSTRUCTIONS

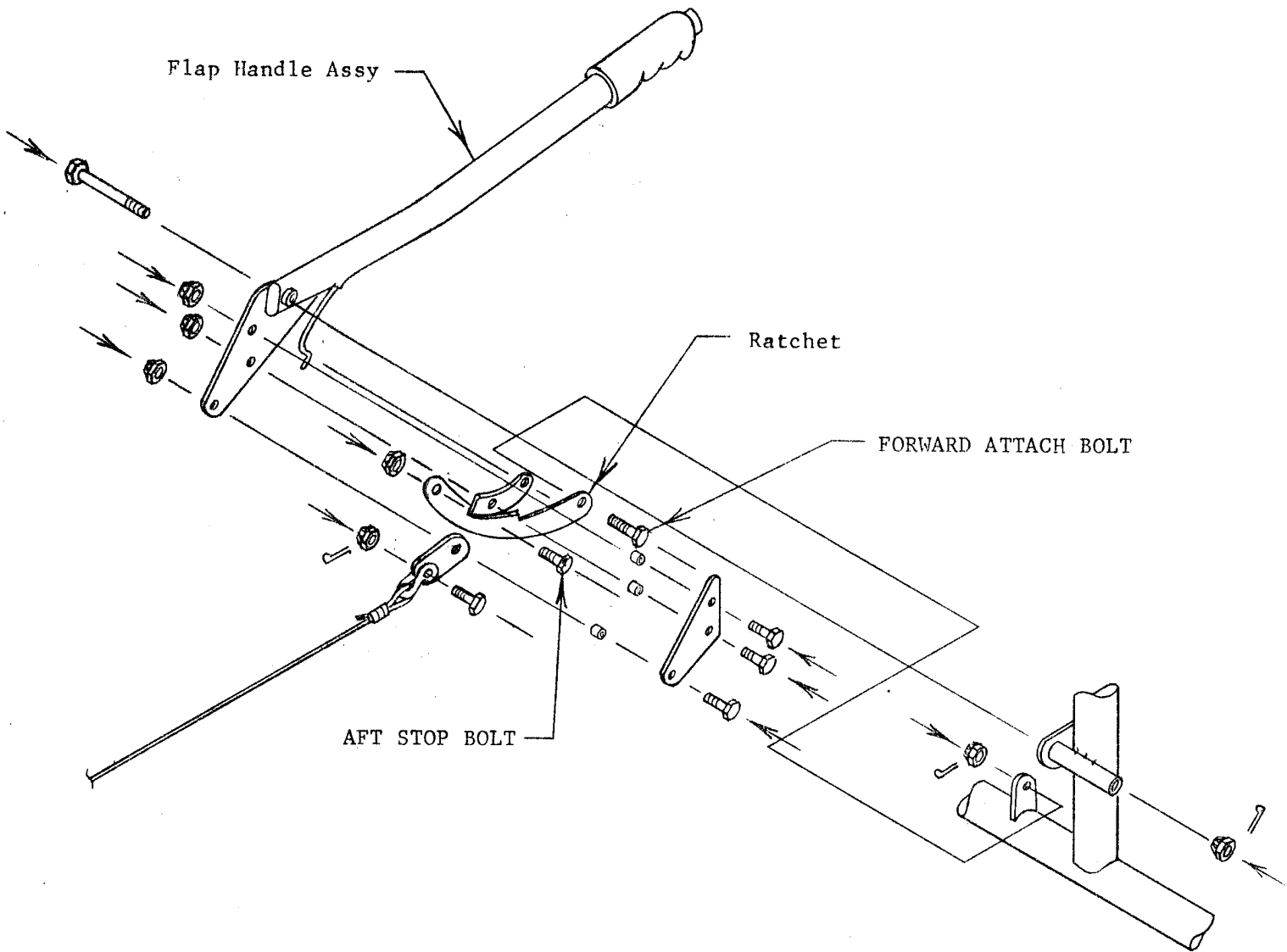

MAULE AIRCRAFT CORPORATION

SERVICE LETTER # 47 - COMPLIANCE RECORD

Airplane Serial Number _____

Airplane Registration Number _____

The following action was taken with respect to this service letter:

Service Letter # 47 completed

Certified by _____
(Signature)

(Printed name)

Title _____
(Owner, A&P, IA, etc.)

Date performed _____

In an effort to keep our mailing list current for sending service bulletins, service letter, etc., please fill in the following:

Owner's name _____

Owner's address _____

Mail this compliance record to: Maule Aircraft Corporation
Engineering Records
Spence Field
Moultrie, GA 31768

MAULE AIRCRAFT CORPORATION

AIRPLANE FLIGHT MANUAL

MAULE M-5-210TC

Page ii

LOG OF SUPPLEMENTS

| SUPP NO. | NO. OF PAGES | DESCRIPTION | APPROVAL DATE |
|----------|--------------|--|---------------|
| 1 | 2 | Installation of 20°/40° Flap Ratchet (@ 2300# GW) – Maule Service Letter No. 47. | 03/11/83 |
| 2 | 2 | Operation of aircraft @ 2500# GW and Installation of 20°/40° Flap Ratchet – Maule Modification Kit No. 21. | 12/16/98 |
| - | 4 | Installation of Aqua 2200 Floats - STC SA00758CH. | 09/18/97 |
| 4 | 3 | Installation of Fli-Lite Model 3000 MK IIIA Skis – Maule Drawing 9079A . | 06/20/80 |
| - | 2 | Installation of 2110X-30 Wing Assemblies with 2167X Main Fuel Tanks - Modification Kit No. 15. | 10/08/96 |
| - | 5 | Installation of Apollo MX20 Multi-Function Display - Maule Drawing 7265A. | 08/15/02 |
| | | | |

Maule Aircraft Corporation

SPENCE AIR BASE :: MOULTREE, GEORGIA 31768 :: PHONE 912/985-2045

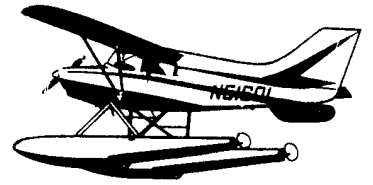

FAA APPROVED

AIRPLANE FLIGHT MANUAL SUPPLEMENT NO. 1

FOR

MODEL M-5-210TC

Reg. No. _____

Ser. No. _____

This Supplement must be attached to the FAA Approved Airplane Flight Manual dated 4 February 1980 when ratchet p/n 3207 is installed in accordance with Maule Service Letter #47.

The information contained herein supersedes and supplements the information of the basic Airplane Flight Manual; for limitations, procedures and performance information not contained in this Supplement, consult the basic Airplane Flight Manual.

FAA APPROVED:

John R James

Manager, Atlanta Aircraft Certification
Office, FAA, Central Region

DATE: Mar. 11, 1983

MAULE AIRCRAFT CORPORATION

MOULTRIE, GEORGIA

AFM SUPPLEMENT NO. 1

M-5-210TC

I. LIMITATIONS

The following limitations must be observed in the operation of this Airplane:

F. Airspeed Limits: (CAS)

NOTE: Airspeed Instrument Markings and their significance:

- (d) WHITE arc denotes flap operating range, 54 - 94 mph (47 - 82K): Extends from full flap, power off minimum steady flight speed at 2300 lbs. From (V_{SO}) to the maximum flaps extended speed (V_{FE}).

II. PROCEDURES

A. Normal Procedures

1. Wing Flap Settings:

- Takeoff - Normal - 20° (First Notch). No-Flap (0°) takeoff permissible
- Shortfield - 40° (Second Notch) until safely airborne, then retract to 20°

Normal Climb - 0°

Best Angle Climb - 20°

Landing - 40° (0° or 20° permissible)

3. Best Rate of Climb - 90 mph CAS, no flaps

Best Angle of Climb - 75 mph CAS, 20° flaps